



2017 PRIZE LIST



TABLE OF CONTENTS

DRESSAGE WINNIPEG 2017 COMPETITION DETAILS	PAGE 3
EQUESTRIAN CANADA STATEMENT OF PRINCIPLES	PAGE 4
DRESSAGE WINNIPEG - CHANGES FOR 2017	PAGE 5
2017 EC AMENDMENTS & RULE CHANGES	PAGE 6
COMPETITION CLASSIFICATION & RIDER CATEGORIES	PAGE 7
GENERAL RULES & CONDITIONS OF ENTRY	PAGE 8
PRIZES AND AWARDS	PAGE 14
SCHOLARSHIPS AND OTHER PROGRAMS	PAGE 16
YEAR END AWARDS	PAGE 16
2017 AWARDS OF EXCELLENCE FORM	PAGE 18
MANITOBA HORSE COUNCIL FACILITY MAP	PAGE 19
FRIDAY WARM-UP FORM	PAGE 20
RING 3 RIDE REQUEST FORM	PAGE 21
BRONZE COMPETITION ENTRY FORM	PAGE 22
GOLD COMPETITION ENTRY FORM	PAGE 24
GOLD PROVINCIAL CHAMPIONSHIPS ENTRY FORM	PAGE 26
WAIVER	PAGE 28

2017 EQUESTRIAN CANADA GOLD & BRONZE COMPETITIONS

Show Manager: Sue Matthews, 10 Cooks Cove, Oakbank, Manitoba ROE 1J1
(204) 444-5146 or (204) 298-4995 sue@dressagewinnipeg.com

Show Office Assistant: Susan Canal

Volunteer Coordinator: Rhonda Wall-Dueck rhonda@dressagewinnipeg.com

May 27th & 28th

Dressage Winnipeg Memorial Competition

(In memory of Kendra McBain and Sheryl Feller)

Entry Deadline: Midnight Friday, May 12th

Location: MHC Equestrian Facility, Birds Hill Park, Oakbank, Manitoba

Judge: Birgit Valkenborg EC (S)

Steward: Daryl Freed EC (M) and Michelle Taplin EC (M)

June 24th & 25th

Dressage Winnipeg Capt. de Kenyeres Memorial Competition

Midnight Friday, June 9th

Location: MHC Equestrian Facility, Birds Hill Park, Oakbank, Manitoba

Judges: Elaine Potter EC (M carded to S) and Elaine Banfield EC (M)

Stewards: Michelle Taplin EC (M) and Ruth Hoeschen EC (B)

August 5th & 6th

Dressage Winnipeg Midsummer Madness Competition

Midnight Friday, July 21st

Location: MHC Equestrian Facility, Birds Hill Park, Oakbank, Manitoba

Judge: John MacPherson EC (S)

Stewards: Michelle Taplin EC (M)

September 9th & 10th

Dressage Winnipeg Autumn Classic Competition

Manitoba Provincial Championship (Gold)

Midnight Friday, August 25th

Location: MHC Equestrian Facility, Birds Hill Park, Oakbank, Manitoba

Judges: Joan Macartney EC (S), Heather Joanne White EC (S)

Stewards: Susan Adey EC (S) and Michelle Taplin EC (M)

The above competitions are sanctioned as Bronze and Gold member competitions of Equestrian Canada, 308 Legget Drive, Suite 100, Ottawa, Ontario, K2K 1Y6 and are governed by the rules of EC. (Article 602.1)

EMERGENCY PRECAUTIONS

Veterinarian on call: Dr. Glenn Sinclair

Farrier on call: A list of names will be available in the show office.

Emergency medical plan: Cell phones on site at all times to call 911 for ambulance.

First Aid: Trained personnel will be on site for each competition.

EQUESTRIAN CANADA STATEMENT OF PRINCIPLES

Equestrian Canada (EC), the national equestrian federation of Canada, supports adherence to the humane treatment of horses in all activities under its jurisdiction.

All persons shall be committed to:

Upholding the welfare of all horses, regardless of value, as a primary consideration in all activities;
Requiring that horses be treated with kindness, respect and compassion, and that they never be subjected to mistreatment;

Ensuring that all equestrians including owners, trainers and competitors, or their respective agents, use responsible care in the handling, treatment and transportation of their own horses as well as horses placed in their care for any purpose;

Providing for the continuous well-being of horses by encouraging routine inspection and consultation with health care professionals and competition officials to achieve the highest possible standards of nutrition, health, comfort and safety as a matter of standard operating procedure;

Providing current information on code of practice for the care and handling of equines and other equine health and welfare initiatives;

Continuing to support scientific studies on equine health and welfare;

Requiring owners, trainers and competitors to know and follow their sanctioning organization's rules, and to work within industry regulations in all equestrian competitions;

Actively promoting the development of, and adherence to competition rules and regulations that protect the welfare of the horse.

The standard by which conduct or treatment will be measured is that which a person who is informed and experienced in generally accepted equine training and competition procedures would determine to be neither cruel, abusive, nor inhumane.

DRESSAGE WINNIPEG – 2017 CHANGES

SUBMITTING ENTRIES:

Hard copy entry forms and Online entries will be available through the Dressage Winnipeg website with credit card payments accepted via PayPal for Online entries. A \$10 fee will now be charged for **incomplete entries** received by the Show Manager. Please make sure your entry is complete with ALL of the information required. **Late entries** may now be accepted and a \$20 fee will be charged subject to availability and accommodating within the time parameters of scheduling.

WAIVERS:

A signed waiver per horse/rider combination MUST be provided to the show office prior to riding on the competition grounds. Riding will NOT be permitted without a signed waiver (this includes coaches warming up a students' horse.)

MANITOBA HORSE COUNCIL MEMBERSHIP:

No riding on competition grounds will be permitted without a valid Manitoba Horse Council membership. Manitoba Horse Council Temporary Memberships will NOT be available for purchase at the Competitions.

SCHEDULING CONFLICTS:

The Show Manager will take into account scheduling conflicts for horses or riders only. Due to the difficulty of scheduling we will not take into account coaching conflicts or horses sharing tack. It is the responsibility of the competitors to ensure they have adequate tack for all horses entered.

FEE INCREASES:

The one night stabling fee has increased by \$10 to bring it in line with the weekend stabling fee. Bronze competition test fees increased by \$5 per test; they are now the same as the Gold competition test fee.

RING 3:

Ring 3 will now be available on Saturday and Sunday for warm ups at a cost of \$20 per rider, per day. (On a trial basis at the May Competition)

RING 4:

Ring 4 will be used for lungeing. The Show Manager reserves the right to not provide a lungeing ring or to change the allocated ring at any time during the competition season.

CLASS CHANGES:

Walk/Trot classes are now being offered at the Bronze and Gold Level in Open, AA and JR.
Western Dressage classes, Open Introductory, Basic and Level 1, are now being offered at the Bronze Level.
Third and Fourth Level classes are now being offered at the Bronze Level in Open, AA and JR.
FEI young horse class will only be offered at the September Autumn Classic Gold Competition.

RIBBONS:

Ribbons will be given to fourth place only. Fifth place ribbons have been eliminated.

CHAMPIONS AND RESERVE CHAMPIONS:

We will now be calculating the champions and reserve champions in accordance with the Foxvillage high-point reporting system, the person with the 2 highest scores in their respective level will be awarded the championship, the person with the next highest score will be awarded the reserve championship. All tests over both days will count towards the calculation and you must ride both days to be eligible to win the championship or reserve championship.

Bronze and Gold Freestyle Champions will now be calculated from all levels combined (except at the Provincial Championships, where there will be an award for each level).

AWARDS & PRIZES:

Awards of Excellence criteria have been changed to bring them in line with the EC Achievement awards.

The Rising Star award eligibility has been changed.

The Year End Provincial Championship and Spirit of Dressage annual plaques will be archived - recipients will now receive an award to keep.

Provincial Championship prizes will now be presented at the Awards Banquet to allow time for personalization. The calculation of the yearend High Point awards has been explained in greater detail.

2017 EQUESTRIAN CANADA AMENDMENTS & RULE CHANGES:

There were changes to both EC General Rules (Section A) and EC Dressage Rules (Section E) released for 2017 available at www.equestrian.ca.

This is not a comprehensive list of all the changes, many changes are of an updating or clarifying nature. Competitors are responsible for knowing and following all of the rules.

EQUESTRIAN CANADA AMENDMENTS GENERAL (SECTION A) 2017:

Equine Canada has changed its name to Equestrian Canada.

Competitors are encouraged to read chapter 1 (**Article A101**) regarding accidents and return to play.

Passports have been replaced with Digital Horse Recordings chapter 4 (**Article A401 to A412**).

Please note effective January 1st 2017 EC Passports will NOT be accepted at Competitions you MUST have an EC Digital Horse Recording

Horses entered in Gold competitions ARE required to hold both a digital EC horse recording number AND have paid the horse recording annual activation fee to compete, or if owned by a Temporary sport license holder, a Temporary horse registration form must be purchased at each competition entered. Foreign entries must sign an affidavit. (**A602.4**)

Intrasynovial Joint Injections (joint, tendon sheath or bursal) are prohibited within 96 hours of competition (**Article A1013**).

EQUESTRIAN CANADA AMENDMENTS DRESSAGE (SECTION E) 2017:

Competitors are encouraged to read the 2017 Equestrian Canada Dressage rules (**Section E.**)

CLASSIFICATION OF COMPETITION

1. BRONZE COMPETITIONS:

Show results are NOT submitted to Equestrian Canada.

BRONZE COMPETITION REQUIREMENTS	LOCAL	PROVINCIAL	EQUESTRIAN CANADA		AWARD ELIGIBILITY <i>As specified in 2017 Prize List</i>
	Club Membership	Provincial Membership	Sport License	Digital Horse Recording	
RIDER and OWNER	ONE OF THE FOLLOWING: <input type="checkbox"/> Dressage Winnipeg (Senior, Junior, Temp) <input type="checkbox"/> Western Dressage <input type="checkbox"/> Westman Dressage <input type="checkbox"/> Manitoba Pony Club <input type="checkbox"/> Manitoba Horse Trials	<input checked="" type="checkbox"/> Manitoba Horse Council	<input checked="" type="checkbox"/> Bronze (Minimum)		<input checked="" type="checkbox"/> Competition <input checked="" type="checkbox"/> Year End
PERSON RESPONSIBLE			<input checked="" type="checkbox"/> Bronze (Minimum)		

2. GOLD COMPETITIONS:

Show results ARE submitted to Equestrian Canada.

GOLD COMPETITION REQUIREMENTS	LOCAL	PROVINCIAL	NATIONAL	EQUESTRIAN CANADA		AWARD ELIGIBILITY <i>As specified in 2017 Prize List</i>
	Club Membership	Provincial Membership		Sport License	Digital Horse Recording	
RIDER and OWNER	ONE OF THE FOLLOWING: <input type="checkbox"/> Dressage Winnipeg (Senior, Junior, Temp) <input type="checkbox"/> Western Dressage <input type="checkbox"/> Westman Dressage <input type="checkbox"/> Manitoba Pony Club <input type="checkbox"/> Manitoba Horse Trials	<input checked="" type="checkbox"/> Manitoba Horse Council	RIDER ONLY: <input checked="" type="checkbox"/> Dressage Canada Affiliate Member	<input checked="" type="checkbox"/> Gold (Minimum)	<input checked="" type="checkbox"/> Digital Horse Record <input checked="" type="checkbox"/> Paid Annual Activation Fee	<input checked="" type="checkbox"/> Competition <input checked="" type="checkbox"/> Year End <input checked="" type="checkbox"/> Provincial <input checked="" type="checkbox"/> Dressage Canada Horse Achievement <input checked="" type="checkbox"/> Dressage Canada Rider Achievement <input checked="" type="checkbox"/> Lauren Dilanni Freestyle
PERSON RESPONSIBLE				<input checked="" type="checkbox"/> Gold (Minimum)		

RIDER CATEGORY

OPEN	AMATEUR	JUNIOR
Open to all competitors, regardless of age or status. (Article E 3.4.1)	Open to competitors who hold amateur status issued by EC on their EC sport license card who are no longer Juniors under Article E 3.4.3 (except as outlined in Article E 3.4.2) and competitors who are not earning remuneration from teaching or training in the horse industry. Some exceptions apply (see Article E 3.4.2 - Amateur status)	Open to all competitors until the end of the calendar year in which they reach the age of 18 (Article E 3.4.3)

GENERAL RULES & CONDITIONS OF ENTRY

EQUESTRIAN CANADA RULES: Please use 2017 EC Dressage Rules in conjunction with 2017 EC General Regulations. Every class offered herein is covered by the Rules and Specifications of the current (2017) rules of Equestrian Canada and will be held and judged in accordance with the EC Rule Book (**Article A602.2**) Per Article **A801**, every entry at an EC sanctioned competition shall constitute an agreement by the person responsible that the owner, lessee, trainer, manager, agent, coach, driver, rider and horse shall be subject to the EC constitution and all rules of EC and any additional rules set by the competitions. It is the responsibility of all individuals participating in any capacity in EC sanctioned competitions to be knowledgeable regarding the EC constitution and the applicable rules of EC and the additional rules, if any, imposed by the competition. Do not participate in these EC sanctioned competitions in any capacity if you do not consent to be bound by the constitution and rules of EC and any additional rules imposed by the competition. (**Article A602.7**)

CURRENT DRESSAGE TESTS: Equestrian Canada will use the USEF 2015 dressage tests. ALL dressage tests are available from www.equestrian.ca/dressage or www.fei.org for download.

DIRECTIONS & PARKING: For arrival and departure of trailers and parking for competitors and visitors see map on page 19. Parking arrangements for horses trailering in will be available at the show office.

EQUESTRIAN CANADA MEDICATION CONTROL: Gold and Bronze competition entries are required to follow Equestrian Canada Medication Control Rules. A mandatory drug testing fee will be charged for each horse entered in the competition (\$3.50 Bronze, \$7.00 Gold). Any horse, entered in any class at an EC competition, may be selected for equine medication control testing while on the competition grounds (**Article A602.5**).

ENTRIES: Proof of all required memberships and original waivers must be presented at the show office prior to or upon arrival to validate your entries. For subsequent competitions in which you enter, proof of all memberships will not be necessary and new waivers will only be required if a horse/rider combination changes. If you do not have your membership proof, you will not be allowed to show without purchasing the appropriate temporary membership(s) if available. Dressage Winnipeg accepts, Western Dressage, Westman Dressage, Manitoba Pony Club or Manitoba Horse Trials memberships in lieu of a Dressage Winnipeg membership, or memberships from dressage clubs based in other provinces (for competitors coming in from out of province). No competitor will be allowed to ride without a completed waiver form. Failure to check in at the show office will result in elimination from the class. No refunds will be given (**Article A518.3**).

CROSS-ENTERING: More than one rider may ride the same horse/pony at a competition providing the horse/pony is not entered by two riders in the same class. The riders can both be Juniors or Amateur / Open or any combination of these providing they are not in the same class unless the class is divided into separate categories for the purpose of ribbons. (E.g. a horse/pony may enter first level with a junior rider in the Junior and/or Open category. The same horse/pony with a senior rider may enter second level in the Adult Amateur and/or Open category which is the next consecutive level). (**E 7.11.8**)

MAXIMUM NUMBER OF LEVELS/TESTS/CLASSES PER HORSE PER DAY: A horse may compete in any two, but only two consecutive levels and a maximum of four tests per day including the freestyle. More than one rider may compete on a given horse but the horse may not compete against itself. Equitation, Materiale and non-EC classes are included in the maximum of four classes per day. In-hand classes are exempt from this rule. (**E 7.11.9**)

HORS CONCOURS ENTRIES: Hors concours entries may be accepted at the discretion of the competition. These entries must pay the same entry fee and are subject to the same conditions that apply to regular entries. A hors concours entry in freestyle must have qualified to ride the freestyle. Hors concours entries are not eligible for any placings, prizes, or awards. A horse may compete as a hors concours and competitive entry at the same competition. Hors concours entries are not permitted in the Provincial Championship competition. (**E7.11.11**)

LIMIT OF ENTRIES, TIME CHANGES AND CLASS CANCELLATION: The Show Manager for Dressage Winnipeg reserves the right to limit entries, limit tack stalls, combine or cancel classes, alter ring sizes, decide on any point not covered by the rules, and correct any errors or make any necessary changes to the prize list or program during the course of the competition year. Competitors will be notified at the earliest possible time of any changes. The onus will be upon the competitor to familiarize themselves with such changes. In the event of inclement weather the Show Manager will do their best to reschedule classes. Should that not be possible no refunds will be given for cancelled classes.

FAMILIARIZATION: Horses may be entered in the Bronze competition for familiarization at a cost of entry fees: (Administration fee, Bronze drug testing fee, Dressage Canada levy, MHC levy, NCCP levy and stabling.) No classes need be entered. Consideration to competitors must be given i.e. if your horse is causing a disruption please remove it from the competition area. Numbers must be worn at all times.

FREESTYLE TESTS: To enter a Freestyle test in a Gold competition, a horse/rider combination must have received a minimum score of 55% in a dressage test at the same technical level or higher as the freestyle they wish to enter (e.g. 55% in first or second level to compete in the first and/or second level freestyle). The dressage score may have been obtained at an EC Gold or Silver dressage competition prior to the competition, or may be obtained at the same competition in which they wish to enter the freestyle. Proof of the qualifying score is needed (please attach to your entry form). Should you have no previous qualifying score and it was not obtained in your technical class ridden, the rider must withdraw from the class (no refund will be given). Bronze competitions require no minimum technical score. A rider in a Bronze competition may enter a freestyle without having ridden the technical test at the level of freestyle entered **(E10.6)**

PAS De DEUX: Any freestyle entries in the Bronze Competitions at any level may request to ride their freestyle test as a Pas de Deux. (This will be judged separately from the individual freestyle entries). We would love to see some riders creating Pas de Deux rides - just contact the Show Manager and we will create a separate Pas de Deux freestyle class in any Bronze show you wish to enter. Guidelines can be found on www.usdf.org

MUSIC for freestyles is the responsibility of the competitor. Please assign a person responsible for your music to the show office prior to your freestyle. A sound check may be requested on Friday during warm ups.

MISCELLANEOUS CLASSES: Four classes will be offered in the Bronze Competitions. **These classes are NOT eligible for Equestrian Canada Awards.**

Golden Spurs — This class will be sponsored by Bluebear Farms in memory of Sheryl Feller. Competitors must be 50 years of age or older to enter. They ride a test of choice walk/trot through fourth level. The rider with the highest score wins the class and will be awarded a prize. No ribbons Championships or Reserve Championships will be awarded. If riding as a Gold Competitor you may enter this class for the cost of the class fee only. This class will ONLY be offered at the May competition.

Equitation — Competitors entered in the scholarship program will enter this class. You may also enter this class even if you are not entered in the scholarship program. If riding as a Gold competitor you may enter this class for the cost of the class fee only. Ribbons will be awarded through fourth place. No Championships or Reserve Championships will be awarded.

Child Lead Line – Please request a copy of the test to be ridden from the Show Manager. Ribbons will be awarded through fourth place. No Championships or Reserve Champions will be awarded.

Western Dressage- Classes offered will be Open Introductory, Basic and Level 1 Tests A, B, C and D. If riding as a Gold competitor you may enter any of these classes for the cost of the class fee only. Ribbons will be awarded through fourth place. No Championships or Reserve Championships will be awarded.

MEMBERSHIPS AND HORSE REGISTRATIONS:

TEMPORARY SPORT LICENSE- EC: Non Equestrian Canada members will be permitted to exhibit in Gold competitions with the purchase of a Temporary sport license obtained from the show office for a fee of **\$45.00** for each EC sanctioned competition. Temporary Bronze sport licenses are NOT available at competitions. A Temporary sport license is not accumulative and will not apply against payment of a full license, nor does it allow a competitor to qualify for year-end awards, or qualify for championships or competition finals. Only Equestrian Canada members holding Silver or higher sport licenses are eligible to receive Equestrian Canada annual awards. Only Dressage Winnipeg members are eligible to receive Dressage Winnipeg yearend awards.

TEMPORARY MEMBERSHIP MANITOBA HORSE COUNCIL - NOT available for purchase at competitions.

TEMPORARY MEMBERSHIP- DW: Non Dressage Winnipeg members may purchase a Dressage Winnipeg Temporary membership for ONE SHOW ONLY from the show office for a fee of **\$75**. If you intend to compete in more than one Dressage Winnipeg competition in the 2017 competition season, you must become a member. Horse owners of all competition entries must be a general Dressage Winnipeg member (Junior, Senior or Family member).

HORSE REGISTRATION: Horse registrations are mandatory for Equestrian Canada Gold competitions. Those exhibitors planning to compete with a Temporary sport license must purchase a Temporary horse registration for a fee of **\$45** from the show office prior to showing. Foreign horses must sign an affidavit. Horses with registrations must also have paid the annual horse registration fee.

STABLING AND TACK STALLS: Stabling fees will be charged per horse and stalls will be assigned. For the security of all competitors DO NOT change your stall assignment without approval from the show office. Stabling fees include the final cleaning of the stall but will not include any shavings. **Please pre-order your shavings on the entry form at a price of \$8 per bag (Minimum order 2 bags).** Additional shavings will be available for purchase – please see the show office. **At the end of the competition excessively dirty or over bedded stalls will be charged a surcharge of \$10 per stall as per MHC rules. This extra cleaning fee will be invoiced after the competition. Failure to pay the extra cleaning fee will result in the competitor becoming a member not in good standing.** As per MHC rules no competitor is allowed to bring their own shavings onto the competition grounds, they must be purchased through the show office. Tack stalls are optional. It is the responsibility of the competitor to find someone to share a tack stall with if it is his or her wish. To comply with fire rules and insurance regulations tack, boxes, and bedding, etc. must NOT be stored in the aisles as they must be clear at all times in case of emergency.

TRAILERING IN: Trailering in will be allowed at a cost of \$12 per horse, per day. As per MHC rules no horse may be left in a trailer overnight. Trailers must be parked in the area designated by the Show Manager, please check at the show office upon arrival at the competition grounds. Horses tied to a trailer must be supervised at all times and have adequate food and water. No horse may leave the competition grounds until it has finished its last class of the day. **Trailering in will NOT be allowed if entering the Manitoba Gold Provincial Championship. All competitors must register at the show office before riding. Failure to do so will result in elimination from the class. No refunds will be given (Article A518.3).** Upon leaving the competition grounds the trailering area must be left in a clean and undamaged state otherwise extra clean up fees will apply and trailering privileges will be revoked for future competitions. All horses and competitors trailering in are bound by the rules and regulations pertaining to Equestrian Canada competitions.

CANCELLATION: Competitors canceling before the competition entry closing date will be refunded all fees minus the administration fee. Competitors cancelling after the competition entry closing date but before the start of the competition will be refunded all fees minus the administration fee upon receipt of a veterinarian's certificate for the horse or a doctor's certificate for the rider. Competitors canceling after the start of the competition will only be refunded any fees for classes not ridden upon receipt of a veterinarian's certificate for the horse or a doctor's certificate for the rider. Documentation must reach the Show Manager within 30 days of the last day of the competition.

REPORTING FOR COMPETITION: All competitors **MUST** report to the show office upon arrival and before riding to verify membership cards, ensure waivers have been signed and confirm that all is in order with your entry forms and classes and pay any fees owing. Failure to do so will result in elimination from either your warm up ride or your class and no refunds will be given. (Article A518.3). For security reasons we also need to know which horses are on the grounds and ensure that we have the correct contact information. The show office is open from 12 noon until after the last warm up ride on Fridays, and opens one hour before the competition starts on Saturday and Sunday until the last ride of the day is completed. For those arriving Friday afternoon, please report to the show office as early as you can. This will allow those who arrive later Friday evening or early Saturday morning a chance to sign in and give the show office more time Saturday morning to prepare for the judges and set up for the competition.

NUMBERS: Must be worn and visible at all times in the warm-up, schooling and/or exercise areas as well as in the competition rings, whether the horse is under saddle or not. This requirement includes familiarization horses. **You MUST have a number on BOTH sides of your horse so it is visible from both sides.** Numbers will be available for purchase at the show office for \$6 per set.

SHOW SCHEDULE: Warm-ups will be available after 1pm on Fridays and after 8:00am on Saturday and Sunday. DO NOT warm up until the Stewards are on site. Competitions generally start around 9:00 am on both Saturdays and Sundays and continue until completion of the classes based on entries. In the event of changes to the schedule (e.g. due to scratches), day sheets will be posted daily in the mornings of competition. These sheets will inform all competitors of the most current and correct order of go and will override previous scheduling. It is the competitors' responsibility to check for any possible changes.

SUBSTITUTION FEES: There will be a \$10 fee for substituting a horse and/or rider competition entry after the entry closing date but before the competition has started. After the competition has started any changes to a rider or horse will be considered a new entry, a new number will be issued and all appropriate fees must be paid. New waivers must be signed and memberships or temporary memberships must be in place.

WARM UP: Horses may be schooled only in designated areas. On Friday after 1PM and Saturday and Sunday after 8AM horses may be schooled in the group warm up ring. Use of Ring 3 will be available for purchase on Saturday and Sunday only at a cost of \$20 per rider, per day (see use of ring 3 request form). DO NOT warm up until the Stewards are on site. Whips, running martingales, boots and bandages are allowed for schooling only. Test calling is NOT allowed in the warm up rings. Only mounted riders are allowed in the warm up rings. Horses may only be ridden in the competition rings on Friday provided a half hour block of time has been purchased (see warm up ride request form).

LUNGEING: Lungeing is not permitted in an area where horses are being ridden. Lungeing (unmounted) and work in hand can only be done by the rider, owner, coach, groom or person responsible and must be under the supervision of a Steward. For lungeing equipment rules, see (E4.9). It is not permitted to lunge riders at any competition, whether or not the horse is entered in the competition. Lungeing is permitted only in designated areas if space permits (Ring 4). Show Organizers are not obliged to provide a lunging area. (E7.16)

CONFLICT OF INTEREST: It is the responsibility of the rider not to enter a class or ride in front of a judge from whom he/she has been instructed, coached or tutored with or without pay the 30 days immediately prior to the date of the competition. (E14.1.1)

CALLERS: A caller for tests will not be provided. Competitors should therefore make their own arrangements. All EC tests may be called during the competition except FEI, Freestyles and tests at Gold championships when all tests must be ridden from memory. Caller's dress code: smart casual; jeans, slacks and mid length shorts are permitted. Inappropriately dressed callers may not be allowed to call a test; tank tops and short shorts are prohibited. Callers may not wear personal electronic devices, e.g. Bluetooth, headphones, etc. while calling tests. (E9.1)

SAFETY HEADGEAR: All riders, regardless of age or level of competition, must wear properly fitted and fastened safety approved protective headgear at all times when mounted at any EC-sanctioned Dressage competition at the event location. **Note:** At the tack check, which follows the test, the steward may ask the rider to dismount so that the helmet may be inspected for the safety standard labelling. **(E4.0)**

STEWARD PRESENTATION: Each competitor in the Bronze and Gold competition is responsible for presenting their horse to the steward for inspection immediately after they have completed their test and leave the competition arena. A rider who is eliminated or retires during a test must still report to the steward for a tack check. Any discrepancy to the saddlery or dress rules found by the steward will result in elimination. Failure to report to the steward will result in elimination. Any competitor not ready to enter the competition ring when scheduled will be eliminated. Any competitor failing to enter the competition ring within 45 - 90 seconds of the judge signaling to start will be incurring a -2 penalty. Competitors must enter the competition rings through the warm up ring. Competitors may approach the steward prior to their class if they are uncertain about saddlery or clothing requirements.

HORSES may not be removed from the show grounds until they have completed their last class of the day; however we do encourage you to stay for the presentation of awards. Manitoba Gold Provincial Championship horses may not be removed from the show grounds for any reason unless they are withdrawing from competition completely.

PRESENTATION OF AWARDS: All competition ribbons for classes can be picked up with tests throughout the day at the show office on both Saturday and Sunday. Champion prizes/ribbons and Reserve Champion ribbons will be presented after the completion of the show on Sunday afternoon. To show respect to our sponsors, Dressage Winnipeg requires that all competitors, or their designates, be suitably attired including proper head gear with their bridled horse in hand for presentation of awards. Photos will be taken for publication. Those competitors, or their designates, who do not attend the awards presentation with horse and proper attire will forfeit their ribbon and/or prize.

LIABILITY: It is a condition of entry that neither Dressage Winnipeg, Manitoba Horse Council, Equestrian Canada and any of their officials, volunteers, officers, directors, agents, representatives, employees and the owners and occupiers of the land upon which these competitions are held will be responsible for any liabilities or claims of any nature and kind which may arise from participation in these events. Waivers must be signed by the competitor, person responsible and their parent/guardian (in the case of a junior), as well as the horses' legal owner before the start of the competition.

PROTESTS: A protest at an EC sanctioned competition, other than those specific matters covered in discipline/breed sport rules, must comply with the following provisions:

- a) A protest is eligible only if made by an EC sport license holder (i.e. owner, leasee, trainer, coach, official, competitor or authorized agent) in the division in which the question arises.
- b) A protest must be made in writing and addressed to the Show Manager of the competition at the event that the matter under consideration occurs, it must be signed and it must be accompanied by a deposit of \$100 in cash. **(A 1204)**

COMPLAINTS: A member may file a complaint within 21 days of the date on which the alleged breach of the EC rule or policy occurred. All complaints shall be sent directly to the President of EC together with the required deposit as per the schedule of fines and penalties along with a summary in writing of the reasons and circumstances of the dispute. **(APPENDIX A4)**

DOGS: These are the only animals, other than horses or ponies, permitted on the competition grounds. They must be under control, quiet, and on a leash (no expanding leashes) at all times. Please pick up after your dog, poop bags are available at the Show Office.

NO PHONE OR FAX ENTRIES WILL BE ACCEPTED: All entries must be received by midnight of the closing date. Competition entrants are encouraged to email the show manager to notify her that your entries have been mailed, so that they can be watched for just in case they are delayed in the mail for any reason. Entries must ARRIVE by midnight of the closing date, so please use express post if too close to the closing date, or use the online entry option with credit card payment if there is any chance that your entry will not arrive by the closing date. Phone or fax entries will not be accepted. Late entries may be accepted for a late entry fee of \$20, **only** if space permits and the late entry can be accommodated within the time parameters of scheduling.

WAIVERS: All entries must be accompanied by a hard copy Waiver of Liability duly signed by the appropriate person (rider, owner, parent/guardian and person responsible) and dated (if you entered online a hard copy must also be signed at the show office before riding).

PAYMENT: All entries (whether hard copy or submitted online) must be accompanied by a cheque or credit card payment for the appropriate fees and made out to Dressage Winnipeg (post-dated cheques are NOT accepted).

INCOMPLETE ENTRIES: Incomplete entries will be charged a \$10 incomplete entry fee. Parents or guardians must sign for junior competitors. Failure to do so will result in an inability to participate in the competition.

SUBMIT ENTRIES ONLINE
www.dressagewinnipeg.com

MAIL ENTRIES TO:

Susan Matthews
10 Cooks Cove
Oakbank, MB ROE 1J1
Tel: (204) 444-5146
Cell: (204) 298-4995
Email: sue@dressagewinnipeg.com

Our Judges, Show Officials, and Volunteers work hard to provide you with a high caliber and pleasant competition experience. As such, Dressage Winnipeg expects all competitors to behave in a manner deemed appropriate (as set out in Equestrian Canada guidelines). Any inappropriate behavior to any Judge, Show Official, Volunteer or other Competitors could result in expulsion from our competitions.

We hope everyone enjoys a great season!

PRIZES AND AWARDS

BRONZE AND GOLD COMPETITIONS:

Ribbons are awarded to Fourth place. Any horse receiving less than 40% of the total points obtainable in a test will be eliminated from that class **(E9.9.8)**. Any horse receiving less than 50% of the total points obtainable in a test shall not be eligible for awards, ribbons or prizes **(E9.9.7)**

When there is only one horse in the class, ribbons and prizes shall be awarded in accordance with the following percentages: 1st place 60% or higher, 2nd place 57% to 59.9%, 3rd place 54% to 56.9%, 4th place 51% - 53.9%. No ribbons or prizes shall be awarded below 4th position. **(E9.9.10)**

2017 CHAMPIONSHIP CALCULATIONS:

BRONZE Competition Champion and Reserve Champion calculations will be based on the combination of the two highest scores achieved on either day from any technical test within one level/division. It must be the same horse/rider combination and you must ride on both days to be eligible. Freestyle calculations will be based on the combination of the freestyle score and the highest score from any technical test at the same level as the freestyle ridden. You must ride a minimum of two technical tests plus the freestyle and ride on both days in order to be eligible to win the freestyle Championship.

Champion Prizes and Ribbons and Reserve Champion Ribbons will be awarded for the following:

- JR. Walk/Trot, AA Walk/Trot, Open Walk/Trot
- JR. Training Level, AA Training Level, Open Training Level
- JR. First Level, AA First Level, Open First Level
- JR. Second Level, AA Second Level, Open Second Level
- JR. Third Level, AA Third Level, Open Third Level
- JR. Fourth Level, AA Fourth Level, Open Fourth Level
- Open Freestyle (One award for all levels combined)

GOLD Competition Champion and Reserve Champion calculations will be based on the combination of the two highest scores achieved on either day from any technical tests within one level/division. It must be the same horse/rider combination and you must ride on both days to be eligible. Freestyle calculations will be based on the combination of the freestyle score and the highest score from any technical test at the same level as the freestyle ridden. You must ride a minimum of two technical tests plus the freestyle and ride on both days in order to be eligible to win the freestyle Championship.

Champion Prizes and Ribbons and Reserve Champion Ribbons will be awarded for the following:

- JR. Walk/Trot, AA Walk/Trot, Open Walk/Trot
- JR. Training Level, AA Training Level, Open Training Level
- JR. First Level, AA First Level, Open First Level
- JR. Second Level, AA Second Level, Open Second Level
- JR. Third Level, AA Third Level, Open Third Level
- JR. Fourth Level, AA Fourth Level, Open Fourth Level
- FEI Child, Pony, Junior and Young Rider
- Open FEI Small Tour
- Open FEI Medium Tour
- Open FEI U25 Grand Prix
- Open FEI Grand Prix
- Open Freestyle (One award for all levels combined)

PROVINCIAL CHAMPIONSHIPS:

A Horse/Rider combination must have received at least a minimum score of 55% in another 2017 Gold Dressage Competition to qualify to enter the Manitoba Gold Provincial Championships.

Please mark your highest score from your qualifying competition and the judge from whom you obtained it when filling out your Manitoba Gold Provincial Championships entry form. You can NOT ride the same tests at all in the Bronze or Gold competition as you ride in the Manitoba Gold Provincial Championship.

If you did not meet the qualification requirement for the Manitoba Gold Provincial Championships, you may enter the Autumn Classic Gold or Bronze Competition.

2017 PROVINCIAL CHAMPIONSHIP CALCULATIONS:

Tests available in the Provincial Championship Competition are only the last two technical tests of each level as per Chart (E7.26)

Per Dressage Article **(E7.25.6)** each competitor shall enter and compete in two tests of his/her specific level/division and category (e.g. Junior or Amateur, etc.). The percentages obtained by each competitor in both classes shall be totaled. The competitor with the highest total will be named Champion. The competitor with the second highest total shall be named the Reserve Champion (providing he/she is in accordance with **(E7.25.11)**)

In the event of a tie, the rider with the highest single percentage score is declared the winner. **(E7.25.7)**

At all EC Championship competitions, any horse receiving less than 50% on a technical test will not be eligible for any class awards, championships or reserve championships **(E7.25.11)**

Provincial Champion Prizes & Ribbons and Reserve Champion Ribbons will be awarded for the following:

JR. Walk/Trot, AA Walk/Trot, Open Walk/Trot

JR. Training Level, AA Training Level, Open Training Level

JR. First Level, AA First Level, Open First Level, Open First Level Freestyle

JR. Second Level, AA Second Level, Open Second Level, Open Second Level Freestyle

JR. Third Level, AA Third Level, Open Third Level, Open Third Level Freestyle

JR. Fourth Level, AA Fourth Level, Open Fourth Level, Open Fourth Level Freestyle

FEI Child, Pony, Junior and Young Rider, FEI Pony, Junior, Young Rider Freestyle

Open FEI Small Tour, Open FEI Intermediate Freestyle

Open FEI Medium Tour, Open FEI Grand Prix Freestyle

Open FEI U25 Grand Prix, Open FEI Grand Prix Freestyle

Open FEI Grand Prix, Open FEI Grand Prix Freestyle

Freestyle Champions will be determined by totaling the higher percentage from the two technical classes (of the levels/divisions) plus the percentage from the freestyle **(E 7.25.9)**

FREESTYLE LEVEL

First Level

Second Level

Third Level

Fourth Level

FEI Junior

FEI Pony

FEI Young Rider

FEI Intermediate

FEI Grand Prix

FEI Grand Prix and Grand Prix Special

TECHNICAL TESTS

First 2 & 3

Second 2 & 3

Third 2 & 3

Fourth 2 & 3

FEI Pony Team and Individual

FEI Junior Team and Individual

FEI Young Rider Team and Individual

FEI Prix St. Georges and Intermediate 1

FEI Intermediate 2, U25 Grand Prix

Horse Rider combinations competing in more than one level must choose which level of freestyle they ride.

SCHOLARSHIPS AND OTHER PROGRAMS

DRESSAGE WINNIPEG SCHOLARSHIPS FOR JUNIOR AND AA RIDERS:

The scholarship program will be offered again for 2017. We encourage all eligible riders to enter this scholarship program. Eligibility to apply for the scholarship has been changed. You may now apply for a scholarship in the same age group after two full competition years have passed since you last won a scholarship. Please refer to the Dressage Winnipeg web site www.dressagewinnipeg.com for more information and registration forms or contact Merelyn Hunkin at merelyn@xplorenet.ca

MANITOBA EQUESTRIAN CHAMPIONSHIP EAST WEST CHALLENGE: To be held again from September 23rd to 24th 2017. Please refer to the Manitoba Horse Council web site www.manitobahorsecouncil.com or the Dressage Winnipeg web site www.dressagewinnipeg.com for more information as it becomes available.

GIVE IT A GO: Give it a Go will NOT be held this year.

DRESSAGE WINNIPEG YEAR END AWARDS

All Dressage Winnipeg Year End awards are awarded at the Annual Banquet.

PROVINCIAL CHAMPIONS:

AWARDS: To be presented to the Champions of the Manitoba Gold Provincial Championship in each level/division as outlined in the Prize List. (These will be awards to keep as we will no longer be using the returnable annual plaques)

PRIZES: To be presented to the Champions of the Manitoba Gold Provincial Championships in each level/division as outlined in the Prize List.

THE GILLIAN SEVIER HIGH POINT AWARD: To be presented to the senior rider from Dressage Winnipeg with the highest average percent in both of their technical classes at one level in the 2017 Manitoba Gold Provincial Championship Competition.

THE CAPT. de KENYERES JUNIOR HIGH POINT AWARD: To be presented to the junior rider from Dressage Winnipeg with the highest average percent in both of their technical classes at one Level in the 2017 Manitoba Gold Provincial Championship Competition.

OTHER AWARDS:

RISING STAR AWARD: To be presented to the Dressage Winnipeg rider, aged 21 and under, who has achieved the highest average percent in their technical classes in the current competition season. To be eligible for this award, the rider must have competed in three out of four Dressage Winnipeg competitions during the current Competition season with the same horse. All scores throughout the year will contribute to the calculation. This award can only be won once per rider in a lifetime.

HIGH POINT FREESTYLE AWARD: To be presented to the Dressage Winnipeg rider who has achieved the highest average percent in their Freestyle in the current competition season. To be eligible for this award they must have performed a Freestyle at one level in at least two of the four DW Competitions with the same horse and must have earned a score of over 50%, with at least one of the scores being over 60%. All levels from Bronze and Gold will be combined.

SPIRIT OF DRESSAGE AWARD: To be presented to the person nominated by a Dressage Winnipeg member as a person who has acted as an ambassador for Dressage Winnipeg as well as for the sport of Dressage, who shows concern and awareness for the needs of equine partners, who exemplifies good sportsmanship and who provides support to other members and competitors (excluding paid coaching and training). The person being nominated does not have to be a Dressage Winnipeg Member. The Board of Directors will decide who wins this award once the nomination date has passed.

AWARDS OF EXCELLENCE: SCORES CAN ONLY BE EARNED OVER THE CURRENT COMPETITON SEASON. A Dressage Winnipeg rider must have competed in at least two DW Bronze or Gold competitions in the current competition season, in one level /division and must be the same horse/rider combination to qualify. It is the riders' responsibility to submit proof of tests ridden when submitting the completed Awards of Excellence application form. DW is not responsible for tallying competitors' scores to determine winners of these awards. All applications must have all required scores before the form is submitted. Dressage Winnipeg will accept up to two scores for levels up to and including Third Level and one score at Fourth level and above from any non-DW Equestrian Canada sanctioned Bronze, Silver or Gold competition awarded by an Equestrian Canada certified judge, or from a USDF-sanctioned show. Those applying must be regular members of Dressage Winnipeg and have compiled scores from a minimum of two DW shows. This means that if you compete at an EC sanctioned competition with an EC certified judge in Brandon, out of province, at a rated Pony Club or other competition you can use the scores towards DW Awards of Excellence. These scores are NOT used towards tabulating the High Point Dressage Winnipeg Awards. **Please Note: A rider may not earn two medals of a different color at one level in the same year. Only one medal will be awarded per level per horse/rider combination per year.**

LEVEL	# of scores	BRONZE Minimum %	SILVER Minimum %	GOLD Minimum %	# of different Judges
Walk/Trot	4	64%	66%	68%	3
Training	4	63%	65%	67%	3
First	4	63%	65%	67%	3
Second	4	58%	60%	62%	3
Third	4	58%	60%	62%	3
Fourth	4	58%	60%	62%	2
FEI Child, Pony, Junior, Young Rider	4	56%	58%	60%	2
FEI Prix St Georges	4	56%	58%	60%	2
FEI Intermediate 1	4	56%	58%	60%	2
FEI Intermediate 2	4	56%	58%	60%	2
FEI Grand Prix	4	56%	58%	60%	2

DW YEAR END HIGH POINT AWARDS: One award for each level will be presented to the horse/rider combination that has ridden in at least two DW competitions and obtained the most points within the current competition season. These awards will be calculated over the whole competition season and not by individual competitions. Bronze and Gold competitors JR AA and Open will all be combined when calculating these awards. All scores, excluding Freestyle scores, of 55% and over in tests ridden at DW competitions throughout the current competition season will count in determining points awarded. If you did not ride in at least two DW competitions or have a minimum score of 55% in the test your scores will NOT contribute to the placings and awarding of points. Horse/rider combinations will be placed according to the percentage scored within each level and each test with the highest percentage being 1st place, next highest being second place, next highest being third place and next highest being fourth place. In the event of a tie, both riders will receive equal points for that test. No points will be awarded below fourth place. Once the order has been determined, the following formula will be applied.

PLACING	POINTS	TEST WITHIN THE LEVEL
1st earns	5 x	1 if test 1
2nd earns	4 x	2 if test 2
3rd earns	3 x	3 if test 3
4th earns	2 x	4 if test 4

Example: The highest mark of the competition season in all of First Level Test 2 would earn: 5 points for 1st place (x 2 for Test 2) = 10 points. The second highest mark for First Level Test 2 would earn: 4 points for 2nd place (x 2 for Test 2) = 8 points.)

DRESSAGE WINNIPEG AWARDS OF EXCELLENCE 2017 REPORT FORM

This form is to be used to report dressage test scores earned at Dressage Winnipeg Competitions or EC sanctioned Competitions in the current year. Please report each horse/rider combination on a separate form.

PLEASE NOTE: Must have competed in at least two Dressage Winnipeg Bronze or Gold competitions in 2017, in one level/division, with the same horse/rider combination. Those applying must be regular members of Dressage Winnipeg. Criteria for the award are outlined in the 2017 Dressage Winnipeg prize list. If some of your qualifying scores were earned at an Equestrian Canada sanctioned Competition (not run by Dressage Winnipeg), please attach a photocopy of the test including judge's name and date of competition with your form.

Date	Show	Judge	Test	Score (%)

I DECLARE THE ABOVE INFORMATION TO BE AN ACCURATE RECORD OF SCORES ATTACHED.

NAME OF RIDER	DW MEMBERSHIP #
SIGNATURE	
ADDRESS	CITY
POSTAL	PHONE
EMAIL	
NAME OF HORSE	
NAME OF RIDER	

MUST BE RECEIVED BY: Midnight of October 1, 2017

MAIL TO:
 DRESSAGE WINNIPEG AWARDS COMMITTEE
 Attn: Robyn Cochrane-Fones
 Box 26 GRP 546 RR5, DUGALD, RM of Springfield, MB R2C 2Z2
 Email: robyn@dressagewinnipeg.com

Applicants are encouraged to email Robyn to notify her that your application has been mailed, so that it can be watched for just in case it is delayed in the mail for any reason. Applications must ARRIVE by midnight of the closing date, so please use express post if too close to the closing date. Late applications will not be accepted.

MHC FACILITY- BIRD'S HILL PARK

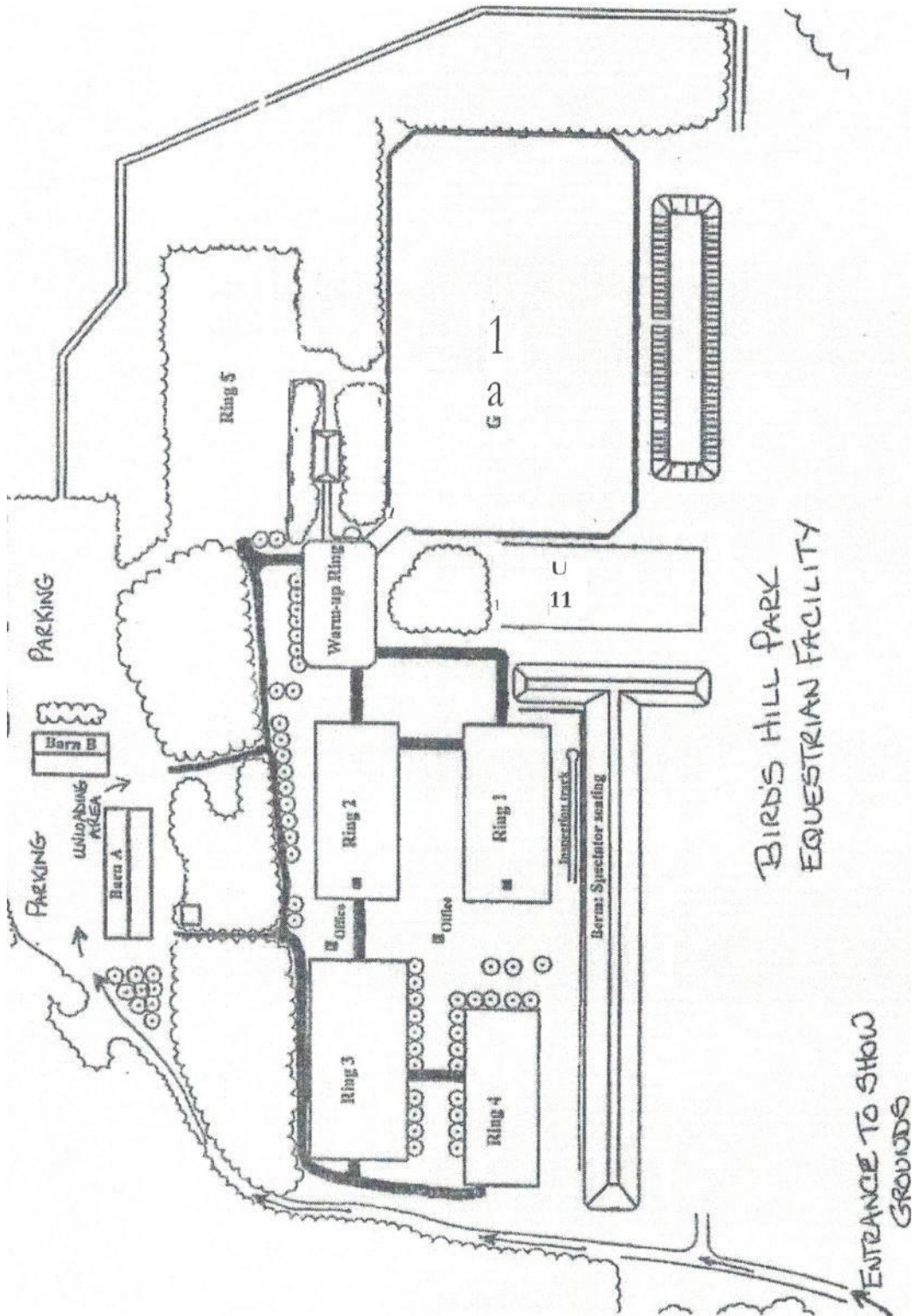

DRESSAGE WINNIPEG WARM-UP REQUEST FORM

Please check show date: **May 27 & 28** **June 24 & 25** **August 5 & 6** **Sept 9 & 10**

RULES & REGULATIONS:

Dressage Winnipeg is offering warm-up rides in Ring 1 & 2 (competition area) on the Friday prior to each competition. Half-hour blocks of time will be available at a cost of \$35.00. Use of Ring 1 & 2 is NOT allowed without purchasing a warm-up slot.

Time slots can be purchased by single riders or by a group of riders who will share the ring during their time slot. Dressage Winnipeg will NOT be responsible for grouping people together to share the rings.

To comply with Equestrian Canada rules, all competitors must have the opportunity to purchase warm-up times. Each horse/rider combination is only allowed ONE half hour time slot to allow all competitors to have the opportunity to purchase time. If there are time slots open after the entry deadline, riders may purchase additional time slots (enquire with Show Manager sue@dressagewinnipeg.com).

ALL RIDERS MUST REPORT TO THE SHOW OFFICE BEFORE RIDING. FAILURE TO DO SO WILL RESULT IN ELIMINATION FROM THE WARM UP RIDE. NO REFUNDS WILL BE GIVEN.

Warm-up schedule will be posted on Dressage Winnipeg's Website www.dressagewinnipeg.com prior to the competition. This will be the only formal notification of your warm-up time slot.

RIDER NAME(S)	
WARM UP TIME SLOTS (Subject to Daylight)	
1PM	1:30PM
2PM	2:30PM
3PM	3:30PM
4PM	4:30PM
5PM	5:30PM
6PM	6:30PM
7PM	7:30PM
TIME SLOT PREFERENCE	
The Show Manager will try to accommodate your first choice, but will not guarantee you will get your first choice .	
1st Choice	
2nd Choice	
3rd Choice	
4th Choice	
RING PREFERENCE (Please check if you have one)	
<input type="checkbox"/> Ring 1	<input type="checkbox"/> Ring 2
SPECIAL REQUESTS (i.e. If you are riding more than one horse, specify time needed between rides, etc.)	

If you purchase a warm-up, please include this with your entry form.

DRESSAGE WINNIPEG: USE OF RING 3 REQUEST FORM

Please check show date: May 27 & 28 June 24 & 25 August 5 & 6 Sept 9 & 10

RULES & REGULATIONS:

ALL RIDERS MUST REPORT TO THE SHOW OFFICE BEFORE RIDING. FAILURE TO DO SO WILL RESULT IN ELIMINATION FROM USING RING 3. NO REFUNDS WILL BE GIVEN.

Use of this Ring may be purchased for \$20 per day, per rider. Use of this ring is NOT allowed without the \$20 per day fee.

This ring is NOT available on Friday. Open any time during competition hours on Saturday and Sunday only.

There will NOT be a dressage ring set up in this ring.

There will NOT be a whipper in stationed at this ring. The rider is responsible for getting to the designated competition warm up area in time for their ride. Failure to do so will result in elimination from that class. No refunds will be given.

Unmounted riders are NOT allowed in this ring.

Test calling is NOT allowed in this ring.

Lungeing is NOT allowed in this ring.

The Show Manager reserves the right to limit the number of riders using this ring.

RIDER NAME	
USE OF RING 3 (Please check)	
<input type="checkbox"/> Saturday \$20	<input type="checkbox"/> Sunday \$20

Please include this request with your entry form.

DRESSAGE WINNIPEG BRONZE COMPETITION ENTRY FORM 2017

Please check show date: May 27 & 28 June 24 & 25 August 5 & 6 Sept 9 & 10

ONLY ONE HORSE/RIDER COMBINATION PER ENTRY FORM

NAME OF HORSE	AGE	HEIGHT	SEX <input type="checkbox"/> Mare <input type="checkbox"/> Gelding <input type="checkbox"/> Stallion	BREED	COLOR
NAME OF RIDER	EC SPORT LICENSE #			MHC #	DW/MHT/MPC/WD or WESTMAN #
ADDRESS	EMAIL ADDRESS			PHONE	CATEGORY <input type="checkbox"/> CHILD <input type="checkbox"/> JUNIOR <input type="checkbox"/> AA <input type="checkbox"/> OPEN
NAME OF OWNER	EC SPORT LICENSE #			MHC #	DW/MHT/MPC/WD or WESTMAN #
ADDRESS	EMAIL ADDRESS			PHONE	
NAME OF PERSON RESPONSIBLE	EC SPORT LICENSE #			EC SPORT LICENSE TYPE <input type="checkbox"/> BRONZE <input type="checkbox"/> SILVER <input type="checkbox"/> GOLD <input type="checkbox"/> PLATINUM	

CIRCLE THE LEVEL, CATEGORY AND TESTS TO BE RIDDEN * MISCELLANEOUS CLASSES, NOT ELEGIBLE FOR EC AWARDS

LEVEL	CATEGORY	SATURDAY TESTS					SUNDAY TESTS					TOTAL
WALK/TROT	JR. AA OPEN	WTA	WTB	WTC	WTD	(\$30/test)	WTA	WTB	WTC	WTD	(\$30/test)	
TRAINING	JR. AA OPEN	1	2	3		(\$30/test)	1	2	3		(\$30/test)	
FIRST	JR. AA OPEN	1	2	3		(\$30/test)	1	2	3		(\$30/test)	
SECOND	JR. AA OPEN	1	2	3		(\$30/test)	1	2	3		(\$30/test)	
THIRD	JR. AA OPEN	1	2	3		(\$30/test)	1	2	3		(\$30/test)	
FOURTH	JR. AA OPEN	1	2	3		(\$30/test)	1	2	3		(\$30/test)	
FREESTYLE	OPEN	1	2	3	4	(\$35/test)	1	2	3	4	(\$35/test)	
EQUITATION *	CHILD JR. AA	EQUITATION (\$30/test)					SATURDAY ONLY					
LEAD LINE *	CHILD (under 12)	TEST B (\$30/test)					TEST B (\$30/test)					
GOLDEN SPURS*	OPEN	TEST OF CHOICE THROUGH 4TH LEVEL MAY SHOW AND SUNDAY ONLY					LEVEL : TEST :					(\$30/test)
WESTERN* INTRODUCTORY	OPEN	A	B	C	D	(\$30/test)	A	B	C	D	(\$30/test)	
WESTERN BASIC*	OPEN	A	B	C	D	(\$30/test)	A	B	C	D	(\$30/test)	
WESTERN LEVEL ONE *	OPEN	A	B	C	D	(\$30/test)	A	B	C	D	(\$30/test)	
TEST SUBTOTAL:												

Continued on next page

If you are aged 21 (or under) please provide date of birth

Please indicate if you would like to be stabled with a particular person or barn

Do you have an NCCP Certified Coach?

Name: _____ NCCP # _____

If your coach does not have an NCCP Number, you must pay the MHC NCCP Levy.

Administration Fee: (MANDATORY)	\$30.00
Bronze Drug Testing Fee: (MANDATORY)	\$3.50
Dressage Canada Levy: (MANDATORY)	\$10.00
MHC Levy: (MANDATORY)	\$3.00
MHC NCCP Coaching Levy: (\$5/entry for non-NCCP certified coach)	
Stabling Fee: (\$65 for one night or \$85 per weekend)	
Tack Stall Fee: (\$45 for one night or \$65 per weekend)	
Shavings: (\$8/bag) 2 3 4 5 6 7 8 9	
Un Serviced Camping Fee: (\$10.50/night)	
Trailer In Fee: (\$12/horse/day)	
DW Regular Memberships: (Senior \$55 or Junior \$45)	
DW Volunteer Payout: (Attach cheque for \$200 dated Oct 1st)	
DW Temporary Membership: (\$75 one competition/year only)	
Warm Up Ride: (\$35/30 mins) <i>See form in Prize List</i>	
Ring 3 Use: (\$20 per rider, per day) <i>See form in Prize List</i>	
Late Fee (\$20)	
TEST SUBTOTAL	
FEE SUBTOTAL	
TOTAL ENTRY FEES	

A signed 2017 Competition Waiver forms part of this entry and MUST be on file at the show office BEFORE riding on the competition grounds.

DRESSAGE WINNIPEG GOLD COMPETITION ENTRY FORM 2017

Please check show date: May 27 & 28 June 24 & 25 August 5 & 6 Sept 9 & 10

ONLY ONE HORSE/RIDER COMBINATION PER ENTRY FORM

NAME OF HORSE	AGE	HEIGHT	SEX <input type="checkbox"/> Mare <input type="checkbox"/> Gelding <input type="checkbox"/> Stallion	BREED	COLOR
NAME OF RIDER	EC GOLD LICENSE #	DC AFFILIATE: <input type="checkbox"/> YES		MHC #	DW/MHT/MPC/WD or WESTMAN #
ADDRESS	EMAIL ADDRESS			PHONE	CATEGORY <input type="checkbox"/> CHILD <input type="checkbox"/> JUNIOR <input type="checkbox"/> AA <input type="checkbox"/> OPEN
NAME OF OWNER	EC GOLD LICENSE #	HORSE REC #	MHC #	DW/MHT/MPC/WD or WESTMAN #	
ADDRESS	EMAIL ADDRESS			PHONE	
NAME OF PERSON RESPONSIBLE	EC SPORT LICENSE #		EC SPORT LICENSE TYPE <input type="checkbox"/> BRONZE <input type="checkbox"/> SILVER <input type="checkbox"/> GOLD <input type="checkbox"/> PLATINUM		

CIRCLE THE LEVEL, CATEGORY AND TESTS TO BE RIDDEN

LEVEL	CATEGORY	SATURDAY TESTS				SUNDAY TESTS				TOTAL		
WALK/TROT	JR. AA OPEN	WTA	WTB	WTC	WTD	(\$30/test)	WTA	WTB	WTC	WTD	(\$30/test)	
TRAINING	JR. AA OPEN	1	2	3		(\$30/test)	1	2	3		(\$30/test)	
FIRST	JR. AA OPEN	1	2	3		(\$30/test)	1	2	3		(\$30/test)	
SECOND	JR. AA OPEN	1	2	3		(\$30/test)	1	2	3		(\$30/test)	
THIRD	JR. AA OPEN	1	2	3		(\$30/test)	1	2	3		(\$30/test)	
FOURTH	JR. AA OPEN	1	2	3		(\$30/test)	1	2	3		(\$30/test)	
FREESTYLE	OPEN	1	2	3	4	(\$35/test)	1	2	3	4	(\$35/test)	
FEI FREESTYLE	FEI	PONY	JR.	YR.	I-1 GP	(\$55/test)	PONY	JR.	YR.	I-1 G	(\$55/test)	
FEI OTHER	CHILD PONY JR YR	PRELIM.	IND.	TEAM		(\$50/test)	PRELIM.	IND.	TEAM		(\$50/test)	
FEI SMALL TOUR	OPEN	PSG	I-1			(\$50/test)	PSG	I-1			(\$50/test)	
FEI MEDIUM TOUR	OPEN	I-A	I-B			(\$50/test)	I-A	I-B			(\$50/test)	
FEI U25 GRAND PRIX	OPEN	I-2	U25GP	GP		(\$50/test)	I-2	U25GP	GP		(\$50/test)	
FEI GRAND PRIX	OPEN	GP	GP SPECIAL			(\$50/test)	GP	GP SPECIAL			(\$50/test)	
FEI YOUNG HORSE	SEPTEMBER ONLY	4Y	5Y PR	6Y PR	7Y PR	(\$75/test)	4Y	5Y PR	6Y PR	7Y PR	(\$75/test)	
TEST SUBTOTAL:												

Continued on next page

If you are aged 21 (or under) please provide date of birth

Please indicate if you would like to be stabled with a particular person or barn

Do you have an NCCP Certified Coach?

Name: _____ NCCP # _____

If your coach does not have an NCCP Number, you must pay the MHC NCCP Levy.

Administration Fee: (MANDATORY)	\$30.00
Gold Drug Testing Fee: (MANDATORY)	\$7.00
Dressage Canada Levy: (MANDATORY)	\$10.00
MHC Levy: (MANDATORY)	\$3.00
MHC NCCP Coaching Levy: (\$5/entry for non-NCCP certified coach)	
Stabling Fee: (\$65 for one night or \$85 per weekend)	
Tack Stall Fee: (\$45 for one night or \$65 per weekend)	
Shavings: (\$8/bag) 2 3 4 5 6 7 8 9	
Un Serviced Camping Fee: (\$10.50/night)	
Trailer In Fee: (\$12/horse/day)	
DW Regular Memberships: (Senior \$55 or Junior \$45)	
DW Volunteer Payout: (Attach cheque for \$200 dated Oct 1st)	
DW Temporary Membership: (\$75 one competition/year only)	
Warm Up Ride: (\$35/30 mins) <i>See form in Prize List</i>	
Ring 3 Use: (\$20 per rider, per day) <i>See form in Prize List</i>	
Late Fee (\$20)	
TEST SUBTOTAL	
FEE SUBTOTAL	
TOTAL ENTRY FEES	

A signed 2017 Competition Waiver forms part of this entry and MUST be on file at the show office BEFORE riding on the competition grounds.

DRESSAGE WINNIPEG GOLD PROVINCIAL CHAMPIONSHIPS ENTRY FORM 2017

September 9th and 10th

**Record highest score at any 2017 Gold Dressage Competition and the Judge who awarded it.
Score must be 55% or higher to qualify to enter Provincial Championship.**

SCORE	JUDGE
--------------	--------------

ONLY ONE HORSE/RIDER COMBINATION PER ENTRY FORM

NAME OF HORSE	AGE	HEIGHT	SEX <input type="checkbox"/> Mare <input type="checkbox"/> Gelding <input type="checkbox"/> Stallion	BREED	COLOR
NAME OF RIDER	EC GOLD LICENSE #	DC AFFILIATE: <input type="checkbox"/> YES		MHC #	DW/MHT/MPC/WD or WESTMAN #
ADDRESS	EMAIL ADDRESS			PHONE	CATEGORY <input type="checkbox"/> CHILD <input type="checkbox"/> JUNIOR <input type="checkbox"/> AA <input type="checkbox"/> OPEN
NAME OF OWNER	EC GOLD LICENSE #	HORSE REC #	MHC #	DW/MHT/MPC/WD or WESTMAN #	
ADDRESS	EMAIL ADDRESS			PHONE	
NAME OF PERSON RESPONSIBLE	EC SPORT LICENSE #		EC SPORT LICENSE TYPE <input type="checkbox"/> BRONZE <input type="checkbox"/> SILVER <input type="checkbox"/> GOLD <input type="checkbox"/> PLATINUM		

CIRCLE THE LEVEL, CATEGORY AND TESTS TO BE RIDDEN

LEVEL	CATEGORY	SATURDAY TESTS	SUNDAY TESTS	FEE	TOTAL
WALK/TROT	JR. AA OPEN	WTC	WTD	(\$100 both tests)	
TRAINING	JR. AA OPEN	TEST 2	TEST 3	(\$100 both tests)	
FIRST	JR. AA OPEN	TEST 2	TEST 3	(\$100 both tests)	
SECOND	JR. AA OPEN	TEST 2	TEST 3	(\$100 both tests)	
THIRD	JR. AA OPEN	TEST 2	TEST 3	(\$100 both tests)	
FOURTH	JR. AA OPEN	TEST 2	TEST 3	(\$100 both tests)	
FREESTYLE	JR. AA OPEN	1 2 3 4	1 2 3 4	(\$55 per test)	
FEI FREESTYLE	FEI	PONY JR. YR.	INTERMEDIATE 1 GRAND PRIX	(\$75 per test)	
FEI OTHER	CHILD PONY JUNIOR	TEAM	INDIVIDUAL	(\$140 both tests)	
FEI SMALL TOUR	OPEN	PRIX ST. GEORGES	INTERMEDIATE 1	(\$140 both tests)	
FEI MEDIUM TOUR	OPEN	INTERMEDIATE A	INTERMEDIATE B	(\$140 both tests)	
FEI U25 GRAND PRIX	OPEN	INTERMEDIATE 2	U25 GRAND PRIX	(\$140 both test)	
FEI GRAND PRIX	OPEN	GRAND PRIX	GRAND PRIX SPECIAL	(\$140 both tests)	
TEST SUBTOTAL:					

Continued on next page

Please indicate if you would like to be stabled with a particular person or barn

Do you have an NCCP Certified Coach?

Name:

NCCP #

If your coach does not have an NCCP Number, you must pay the MHC NCCP Levy.

Administration Fee: (MANDATORY)	\$30.00
Gold Drug Testing Fee: (MANDATORY)	\$7.00
Dressage Canada Levy: (MANDATORY)	\$10.00
MHC Levy: (MANDATORY)	\$3.00
MHC NCCP Coaching Levy: (\$5/entry for non-NCCP certified coach)	
Stabling Fee: (\$85 per weekend)	
Tack Stall Fee: (\$65 per weekend)	
Shavings: (\$8/bag) 2 3 4 5 6 7 8 9	
Un Serviced Camping Fee: (\$10.50/night)	
DW Regular Memberships: (Senior \$55 or Junior \$45)	
DW Volunteer Payout: (Attach cheque for \$200 dated Oct 1st)	
DW Temporary Membership: (\$75 one competition/year only)	
Warm Up Ride: (\$35/30 mins) <i>See form in Prize List</i>	
Ring 3 Use: (\$20 per rider, per day) <i>See form in Prize List</i>	
Late Fee (\$20)	
TEST SUBTOTAL	
FEE SUBTOTAL	
TOTAL ENTRY FEES	

A 2017 Competition Waiver MUST be completed BEFORE riding on the Competition Grounds and forms part of this Competition Entry Form.

2017 DRESSAGE WINNIPEG COMPETITION WAIVER

THIS DOCUMENT WILL AFFECT YOUR LEGAL RIGHTS AND LIABILITIES. PLEASE READ CAREFULLY BEFORE SIGNING

NOTE: This waiver forms part of the entry form and is valid for this rider/horse /owner/person responsible / parent or guardian combination for the entire 2017 Dressage Winnipeg competition season. If any of the above parties change throughout the 2017 competition season, a new waiver must be signed.

I hereby certify that every horse/rider listed on the entry form are eligible as entered and agree for ourselves and our representatives to be bound by the Constitution and rules of Equestrian Canada at these competitions.

It is hereby recognized that all equestrian sports involve inherent risk and that no helmet or protective equipment can protect against all foreseeable injury. I hereby accept this risk and hold harmless Equestrian Canada, the competition, their officials, organizers, agents, employees and their representatives. NOTE: All riders, regardless of age or level of competition, must wear properly fitted and fastened approved protective headgear at all times when mounted at any EC sanctioned competition.

I hereby declare that in making this entry that we have read and fully understand and agree to the terms and conditions stated herein and that it is binding upon our executors, heirs, and assigns.

I agree that any photos taken of this horse/rider at Dressage Winnipeg competitions may be used publicly to promote Dressage Winnipeg as an organization, dressage as a sport or to assist in obtaining sponsorships. I further agree to the release of any information on our entry form to Equestrian Canada.

The person responsible must hold a valid EC sport license at the same level or higher than that which the rider is entering the competition (e.g. Rider entering at gold, person responsible requires valid EC gold or higher sport license)
The person responsible also agrees to the release of any information on the entry form to EC **(A802.4)**

NAME OF HORSE	
NAME OF RIDER	
SIGNATURE - RIDER	DATE
NAME OF HORSE OWNER	
SIGNATURE - OWNER	DATE
NAME OF PERSONAL RESPONSIBLE	
SIGNATURE - PERSON RESPONSIBLE	DATE
NAME OF PARENT/GUARDIAN (JUNIOR RIDERS)	JUNIOR DATE OF BIRTH
SIGNATURE - PARENT/GUARDIAN	DATE

NOTE: REQUIRED FOR JUNIOR RIDERS:

In the event that _____ participates in an Equestrian Canada sanctioned Competition where protective headgear is required for Junior's he/she will wear properly fitted and fastened approved headgear at all times while riding at the event location. It is understood that Junior's not meeting this requirement will not be allowed to compete at these Competitions.